

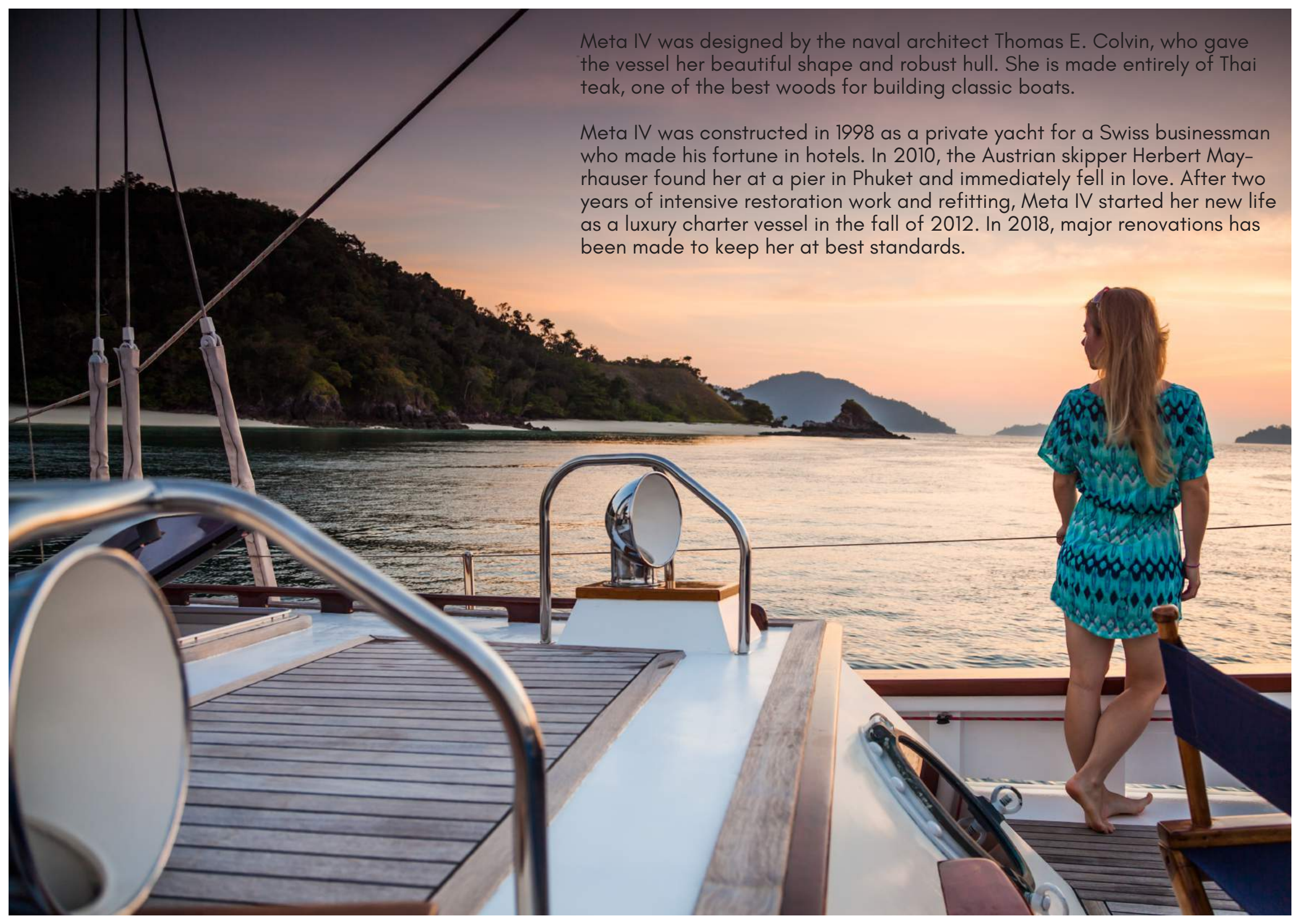

## SY META IV

Ketch • LOA: 25.3 m / 85 ft • Beam: 5.7m / 18.7 ft • Draft: 2.83m / 9.3 ft • Year built 1998 • Refit : 2012 / 2018 • Flag: Myanmar • Engine: 15.7 litre Cummins N-855-M 195 KW • Cruising: 8 knot • Max Speed: 11 knots • Generators: Kohler 7KW • Total sail area: 317 sqm • Electricity: 12V / 24V / 220V • RIB dinghy boat with Yamaha 30HP outboard engine • Hydraulic steering Wagner T-13-35 • Electric anchor windlass • Radar • Crew: 4



Meta IV was designed by the naval architect Thomas E. Colvin, who gave the vessel her beautiful shape and robust hull. She is made entirely of Thai teak, one of the best woods for building classic boats.

Meta IV was constructed in 1998 as a private yacht for a Swiss businessman who made his fortune in hotels. In 2010, the Austrian skipper Herbert Mayrhauser found her at a pier in Phuket and immediately fell in love. After two years of intensive restoration work and refitting, Meta IV started her new life as a luxury charter vessel in the fall of 2012. In 2018, major renovations have been made to keep her at best standards.

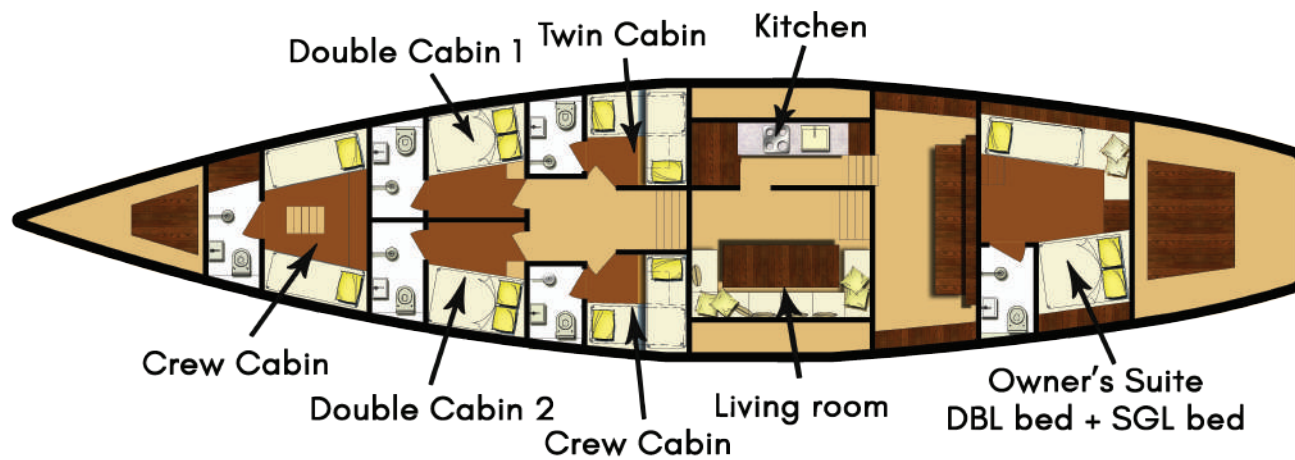

More details : [www.burmaboating.com/metaiv](http://www.burmaboating.com/metaiv)

